

EYEBOW NUT M24 (LIFTING LOOP)

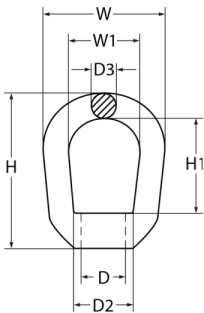

Bow Nut in accordance with requirements of ASME B30.26, used as a removable hanging Eye Nut where a rated male thread or bolt can be utilized commonly used in the Mining Industry.

- Made from G-400 forged steel quenched and tempered with zinc plated finish, manufactured with a bow shape, available in metric thread sizes only.
- Marked with working load limit in tonne, nominal size in millimetre, batch numbered and supplier identification. Proof tested to 2 x Working load limit and Minimum breaking force of 5 x Work load limit.
- Test Certificate are available upon request.



CODE	SIZE (mm)	WLL (tonnes)		WEIGHT (kg)			DIMENSIONS (mm)			
				D	D2	D3	H	H1	W	W1
559390	M24	4.7	1	24	46	21	125	75	98	53