

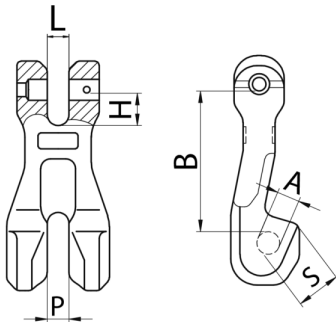

## SHORTENING CLUTCH CLEVIS - LOCKING CLEVIS

Lockable Clutches have the advantage of shortening a Chain Sling without loss of the working load limit. The clevis allows easy connection to Chain with the added safety of a Chain locking device to prevent the Chain to dislodge from the hook.

- Marked with Chain size, product ID, grade with manufacture quality mark
- Manufactured from G80 alloy steel with a safety factor of 4 to 1.
- Conforms to AS3776, Test Certificates available upon request.
- Used in in-line set-up



CODE	SIZE (mm)	WLL (tonne)	WEIGHT (kg)
254308L	7-8	2	0.5
254310L	10	3.2	0.9
254313L	13	5.3	2.1
254316L	16	8	3.7
254320L	20	12.5	5.7